



Yuasa Technical Data Sheet

Yuasa 12N10-3B - Conventional 12 Volt Battery

Performance

Voltage	12V
Capacity (10-hour)	10Ah
Capacity (20-hour)	10.5Ah
CCA @ -18°C	100A

Dimensions (±2mm)

Length	136mm
Width	92mm
Height	146mm

Weights & Measures

Mean Weight with Acid	3.9kg
Acid Volume	0.8l

Technology

Technology	Cast Sb/Sb
Separator	Reinforcing fiber+Glass Fiber



Cell Assembly Layout

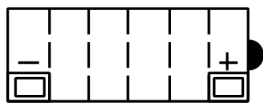

Terminal Type - 6

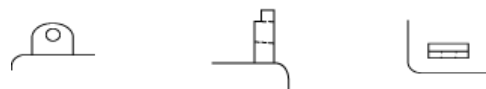

Data Sheet generated on 07/01/2021 - E&OE